

Features

- Grade 75 rebar
- All mechanical and physical properties in accordance with ASTM A615 and CSA G30.18
- Blunt or tapered ends are available
- Available in galvanized (ASTM A123) or epoxy coated (ASTM A775 or ASTM A934)
- Grade 150 is manufactured to ASTM A722 or ASTM A722 physical and mechanical properties only, depending on diameter

Advantages

- Wide range of applications including rock bolts, rock dowels, rock spiles, soil nails, micropiles, etc.
- Suitable for use with either resin cartridges or cement grout
- Resin shredder design actively promotes shredding of film, mixing of resin components and allows for centralizing of bolt within borehole
- Minimum parts and wrenches required for mixing resin and tensioning plate.
- Both domestic and non-domestic products available

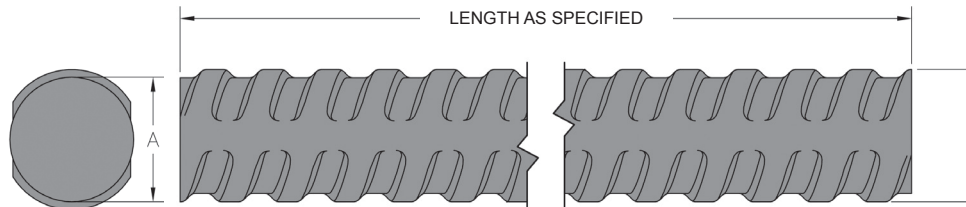

Technical Data - Grade 75 JM Hot Rolled Thread Bar

Bar	Nominal Diameter, in. (mm)	Minimum Net Area Through Threads, in. ² (mm ²)	Yield Strength, Minimum, kips (kN)	Tensile Strength, Minimum, kips (kN)	Nominal Weight, lb/ft (kg/m)	Major Thread Diameter, Approx, in. (mm)
#6	3/4 (19)	0.44 (284)	33 (147)	44 (196)	1.50 (2.24)	0.86 (21.8)
#7	7/8 (22)	0.60 (387)	45 (200)	60 (267)	2.04 (3.04)	0.99 (25.1)
#8	1 (25)	0.79 (510)	59 (264)	79 (351)	2.67 (3.97)	1.12 (28.4)
#9	1-1/8 (29)	1.00 (645)	75 (334)	100 (449)	3.40 (5.06)	1.26 (32)
#10	1-1/4 (32)	1.27 (819)	95 (423)	127 (565)	4.30 (6.40)	1.43 (36.3)
#11	1-3/8 (36)	1.56 (1006)	117 (520)	156 (694)	5.31 (7.91)	1.61 (40.9)
#14	1-3/4 (43)	2.25 (1452)	168.8 (751)	225 (1001)	7.65 (11.38)	1.86 (47.2)

All dimensions, mechanical and physical properties in accordance with ASTM A615. No markings per A615.

Technical Data - Grade 150 JM Thread Bar

	Nominal Diameter, in. (mm)	Minimum Net Area Through Threads, in. ² (mm ²)	Yield Strength Minimum, kips (kN)	Tensile Strength Minimum, kips (kN)	Nominal Weight lb/ft (kg/m)	Major Thread Diameter, Approx, in. (mm)
	1 (26)	0.85 (548)	102 (452)	128 (569)	3.1 (4.6)	1.200 (30.50)
	1-1/4 (32)	1.25 (806)	150 (667)	188 (836)	4.5 (6.7)	1.429 (36.30)
	1-3/8 (36)	1.58 (1019)	190 (845)	237 (1054)	5.7 (8.5)	1.626 (41.30)
	1-5/8 (40)	1.95 (1258)	268 (1192)	297 (1321)	6.9 (10.3)	1.81 (46.0)
	1-3/4 (46)	2.58 (1664)	320 (1423)	390 (1725)	9.1 (13.5)	2.075 (52.70)
	1-7/8 (47)	2.96 (1910)	371 (1650)	409 (1819)	9.5 (14.1)	2.09 (53.1)
	2-1/4 (57)	4.00 (2581)	480 (2135)	600 (2669)	13.6 (20.2)	2.465 (62.60)
	2-1/2 (65)	5.16 (3331)	619 (2753)	774 (3443)	18.3 (27.2)	2.811 (71.40)
	3 (75)	6.85 (4419)	822 (3656)	1028 (4573)	24.0 (35.7)	3.209 (81.50)

Grade 150 bar available hot or cold rolled threads. *1- 5/8 & 1- 7/8 bar hot rolled only.

JM All Thread Bar Accessories



Beveled Washers (ASTM A47 or A536)

Beveled Washers (ASTM A47 or A536)

Bar	Degree of Bevel, °	B- Outside Diameter, in. (mm)	C- Inside Diameter, in. (mm)	Thickness, in. (mm)	
				A - Maximum	D- Minimum
#8	15	2.81 (71)	1.31 (33)	1.00 (25)	0.31 (8)
#9	15	2.81 (71)	1.31 (33)	1.00 (25)	0.31 (8)
#6	9	2.00 (50)	1.00 (25)	0.53 (13)	0.26 (6)
#7	9	2.00 (50)	1.19 (30)	0.56 (14)	0.25 (6)
#10	15	3.375 (85)	1.56 (39)	1.23 (55)	0.375 (9)
#11	15	3.5 (88)	1.75 (44)	1.25 (56)	0.375 (9)
#14	15	5.00 (139)	2.13 (54)	1.81 (82)	0.375 (9)

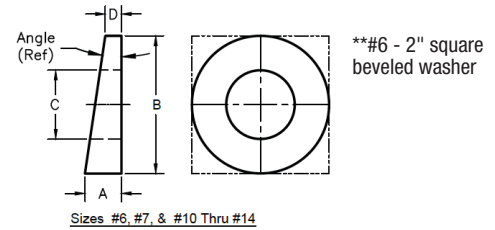
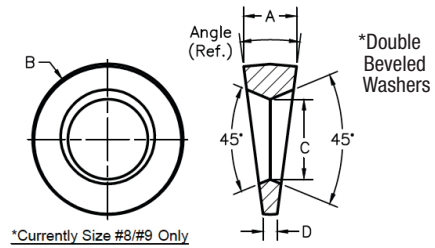

Plates

JENNMAR mining plates shown below according to ASTM A1011, A1018 (adheres to requirements and testing per F432). Plates per ASTM A36, A572, A588 available upon request. All plates made in USA.

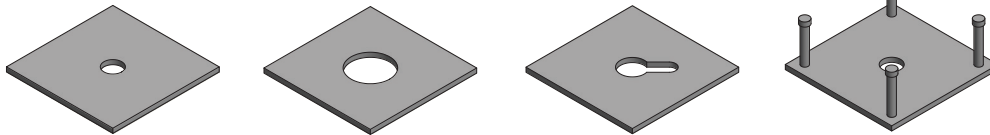

Plate Style	Dimensions, in. (mm)	Dimensions, in. (mm)		
		Nominal Sizes, Square	Nominal Thickness, T	Hole Diameter, H
Flat 	4 x 4 (102 x 102) 5 x 5 (127 x 127) 6 x 6 (152 x 152) 8 x 8 (203 x 203)	1/4 (6.4) 5/16 (8.0) 3/8 (9.5)	1 - 1-5/8 (25.4 - 41.3)	
Dome 	5 x 5 (127 x 127) 6 x 6 (152 x 152) 8 x 8 (203 x 203)	5/32 (4.0) 3/16 (4.8) 1/4 (6.4) 5/16 (8.0)	7/8 - 1-15/16 (22.2 - 49.2)	
Volcano 	6 x 6 (152 x 152) 8 x 8 (203 x 203)	1/4 (6.4) 5/16 (8.0) 3/8 (9.5)	1-3/8 - 1-5/8 (34.9 - 41.3)	

JM Thread Bar Hardware (Black & Galvanized)

	#6	#7	#8
<p>7/8" Hex Socket (or Shank)</p> <p>Note the oval shape of the cross section</p> <p>Oval or Threaded End</p>	Stock	Stock	Stock
	Special Order	Special Order	Special Order
<p>7/8" Hex Socket (or Shank)</p>	Stock	Stock	Stock

Other sizes available by Special Order. T-thread, rope thread, 1" hex, etc .bar spinners and nutrunners available by Special Order.

JM Hot Rolled Thread Bar Accessories

- Various types and sizes of plates can be used in conjunction with JM Thread Bar
- Can be used in conjunction with hex style nut and washer setup or with one piece cast anchor nut
- Couplers are available for applications requiring a coupling device to connect multiple pieces of JM Thread Bar
- All accessories made in USA.

Stop-Type Couplings (ASTM A47 or A536)

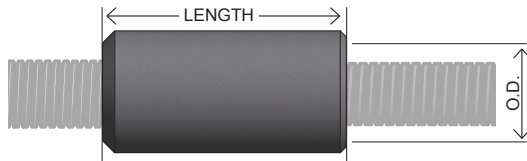

Stop-Type Couplings (ASTM A47 or A536)

Bar	Nominal Diameter, in. (mm)	Outside Diameter, in. (mm)	Overall Length, in. (mm)
#6	3/4 (19)	1.50 (38)	4.13 (105)
#7	7/8 (22)	1.50 (38)	4.33 (110)
#8	1 (25)	1.63 (41)	4.53 (115)
#9	1-1/8 (29)	1.75 (44)	4.92 (125)
#10	1-1/4 (32)	2.00 (51)	5.57 (140)
#11	1-3/8 (36)	2.50 (64)	5.91 (150)
#14	1-3/4 (43)	3.00 (76)	7.62 (193.5)

Hardened Washers (ASTM F436)

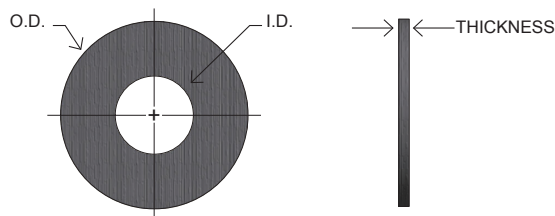

Hardened Washers (ASTM F436)

Bar	Nominal Diameter, in. (mm)	Outside Diameter, in. (mm)	Inside Diameter, in. (mm)	Thickness, in. (mm)
#6	3/4 (19)	1.75 (45)	0.94 (24)	0.156 (4)
#7	7/8 (22)	2.00 (51)	1.13 (29)	0.156 (4)
#8	1 (25)	2.25 (57)	1.25 (32)	0.156 (4)
#9	1-1/8 (29)	2.25 (57)	1.25 (32)	0.156 (4)
#10	1-1/4 (32)	2.75 (70)	1.53 (39)	0.156 (4)
#11	1-3/8 (35)	3.00 (76)	1.63 (41)	0.156 (4)
#14	1-3/4 (45)	3.25 (83)	1.77 (45)	0.156 (4)

Hex Nuts (ASTM A47 or A536)

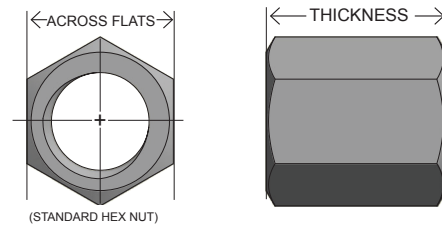

Hex Nuts (ASTM A47 or A536)

Bar	Nominal Diameter, in. (mm)	Across Flats, in. (mm)	Across Corners, in. (mm)	Thickness, in. (mm)
#6	3/4 (19)	1.50 (38.1)	1.44 (37)	1.69 (43)
#7	7/8 (22)	1.50 (38.1)	1.66 (42)	1.77 (45)
#8	1 (25)	1.75 (44.5)	1.88 (48)	1.97 (50)
#9	1-1/8 (29)	2.00 (50.8)	2.16 (55)	2.36 (60)
#10	1-1/4 (32)	2.25 (57.2)	2.50 (64)	2.56 (65)
#11	1-3/8 (36)	2.50 (63.5)	2.75 (70)	2.87 (73)
#14	1-3/4 (43)	3.00 (76.2)	3.60 (91)	3.70 (94)

Spherical Nuts (ASTM A47 or A536)

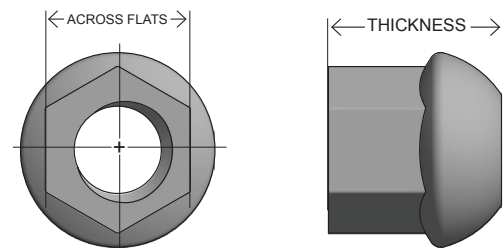

Spherical Nuts (ASTM A47 or A536)

Bar	Nominal Diameter, in. (mm)	across Flats, in. (mm)	Thickness, in. (mm)
#6	3/4 (20)	1.26 (32)	1-1/2 (38.1)
#7	7/8 (22)	1.38 (35)	1-11/16 (42.9)
#8	1 (25)	1.61 (41)	1-13/16 (46)
#9	1-1/8 (29)	1.81 (46)	2-1/4 (57)

JM All Thread Bar Accessories



Beveled Washers (ASTM A47 or A536)

Beveled Washers (ASTM A47 or A536)

Bar	Degree of Bevel, °	B- Outside Diameter, in. (mm)	C- Inside Diameter, in. (mm)	Thickness, in. (mm)	
				A - Maximum	D- Minimum
#8	15	2.81 (71)	1.31 (33)	1.00 (25)	0.31 (8)
#9	15	2.81 (71)	1.31 (33)	1.00 (25)	0.31 (8)
#6	9	2.00 (50)	1.00 (25)	0.53 (13)	0.26 (6)
#7	9	2.00 (50)	1.19 (30)	0.56 (14)	0.25 (6)
#10	15	3.375 (85)	1.56 (39)	1.23 (55)	0.375 (9)
#11	15	3.5 (88)	1.75 (44)	1.25 (56)	0.375 (9)
#14	15	5.00 (139)	2.13 (54)	1.81 (82)	0.375 (9)

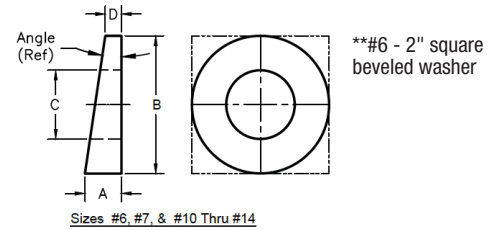
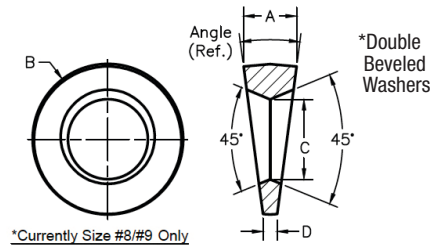

Plates

JENNMAR mining plates shown below according to ASTM A1011, A1018 (adheres to requirements and testing per F432). Plates per ASTM A36, A572, A588 available upon request. All plates made in USA.

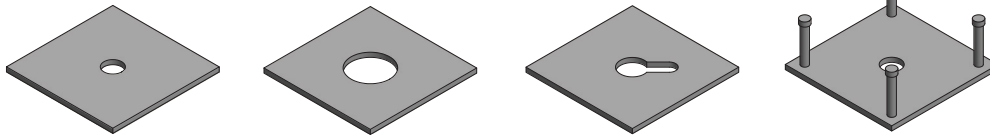

Plate Style	Dimensions, in. (mm)	Dimensions, in. (mm)		
		Nominal Sizes, Square	Nominal Thickness, T	Hole Diameter, H
Flat 	4 × 4 (102 × 102) 5 × 5 (127 × 127) 6 × 6 (152 × 152) 8 × 8 (203 × 203)	1/4 (6.4) 5/16 (8.0) 3/8 (9.5)	1 - 1-5/8 (25.4 - 41.3)	
Dome 	5 × 5 (127 × 127) 6 × 6 (152 × 152) 8 × 8 (203 × 203)	5/32 (4.0) 3/16 (4.8) 1/4 (6.4) 5/16 (8.0)	7/8 - 1-15/16 (22.2 - 49.2)	
Volcano 	6 × 6 (152 × 152) 8 × 8 (203 × 203)	1/4 (6.4) 5/16 (8.0) 3/8 (9.5)	1-3/8 - 1-5/8 (34.9 - 41.3)	

JM Thread Bar Hardware (Black & Galvanized)	#6	#7	#8
<p>7/8" Hex Socket (or Shank)</p> <p>Note the oval shape of the cross section</p> <p>Oval or Threaded End</p>	Stock	Stock	Stock
<p>7/8" Hex Socket (or Shank)</p>	Special Order	Special Order	Special Order
<p>7/8" Hex Socket (or Shank)</p>	Stock	Stock	Stock

Other sizes available by Special Order. T-thread, rope thread, 1" hex, etc .bar spinners and nutrunners available by Special Order.